



15 YEARS ON THE MARKET, 5000 CLIENTS A YEAR



UNIWIN[®]
WINDOWS & DOORS



Unilux

MODERNLINE

ACHTUNG:

weitere

ModernLine-

Zeichnungen in

den anderen

Zeichnungen

enthalten

1

2

3

4

A

B

C

D

DK =

Dreh-Kipp

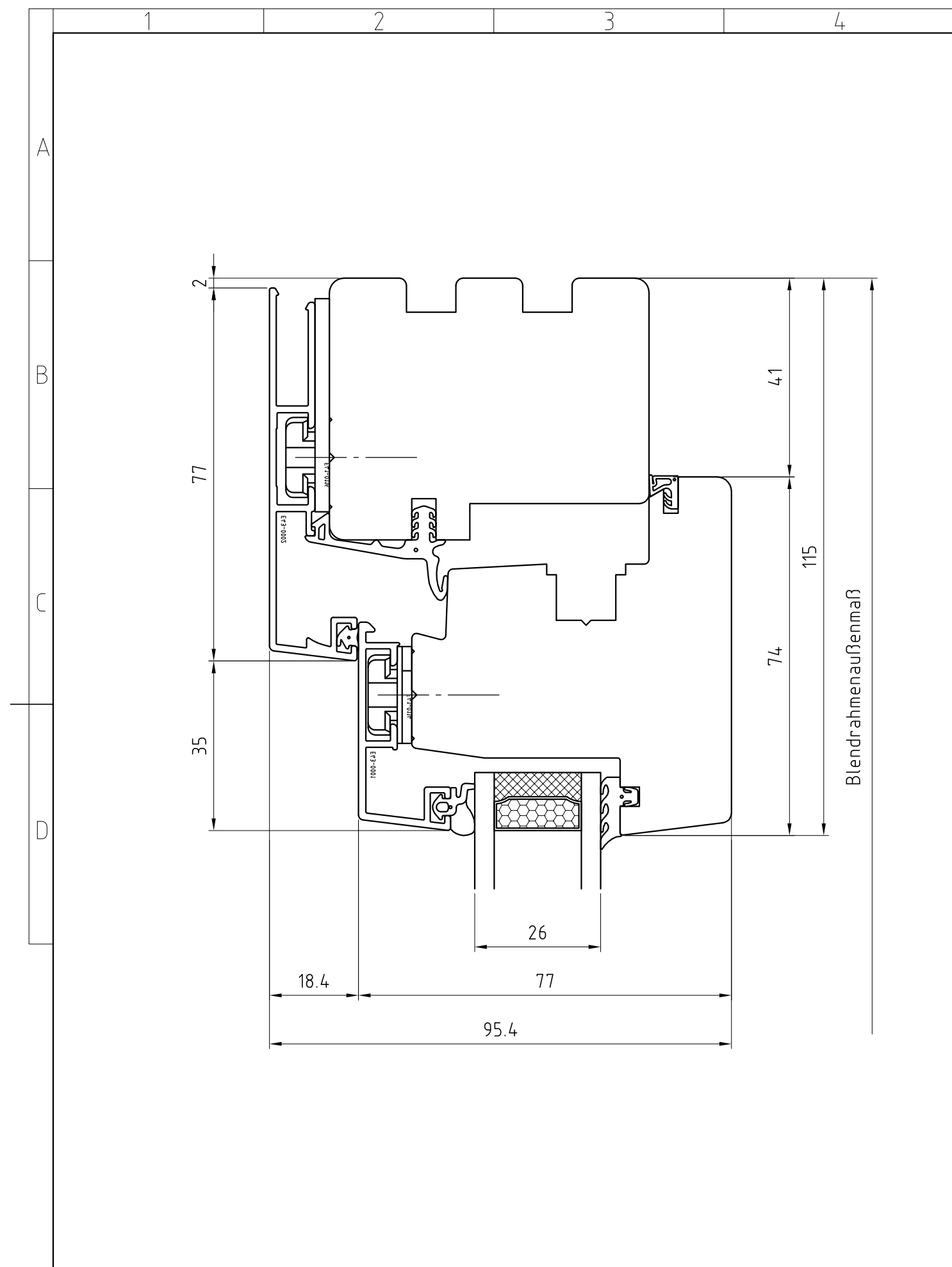

UNILUX®
 Fenster und Türen
 UNILUX AG
 Industriegebiet
 54528 Salmtal
 Tel. 06578/189-0
 Fax 06578/1880

Holz-Aluminium
 ModernLine: DK oben
 Dreh-Kipp

Maßstab 1:1

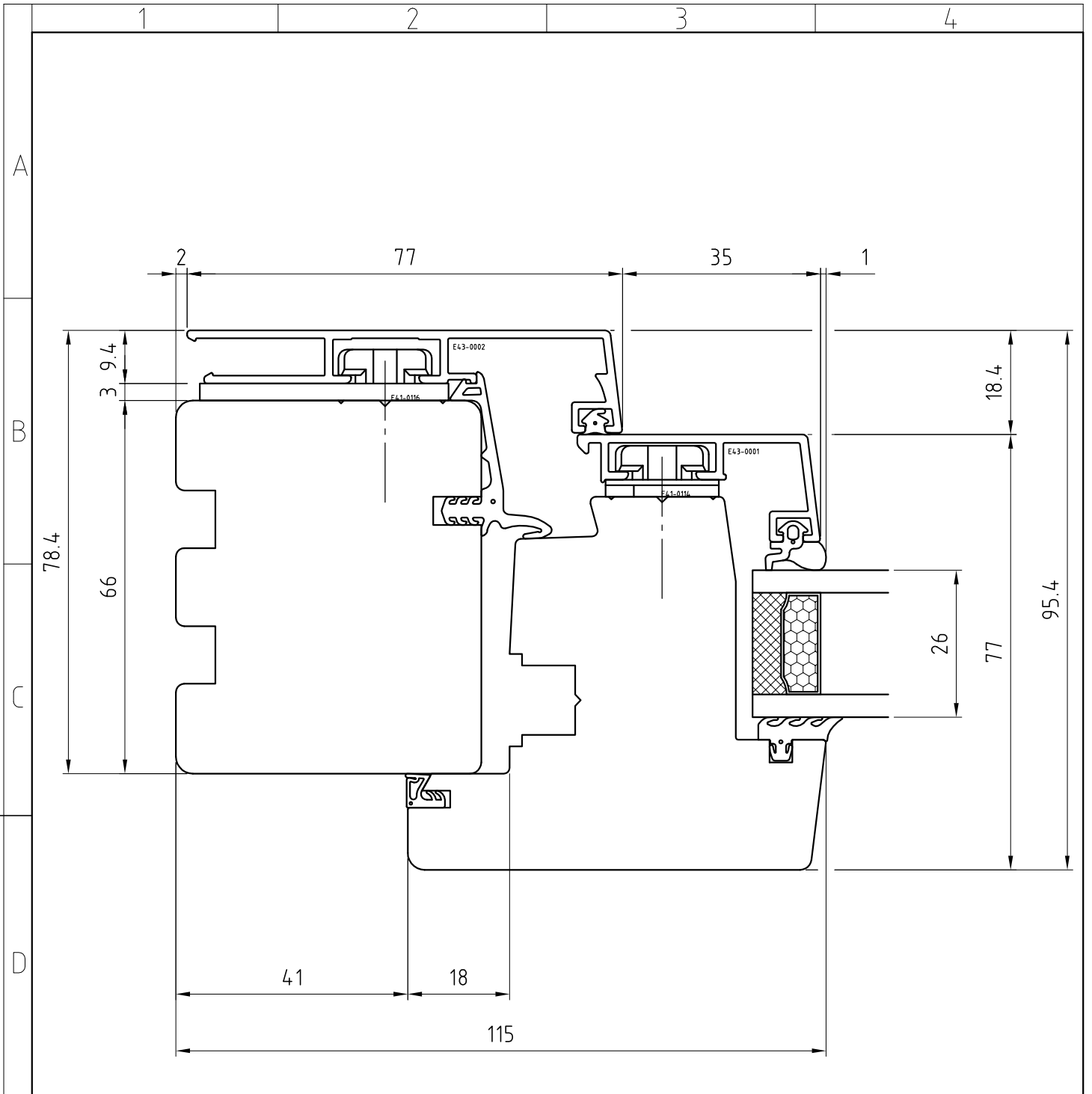

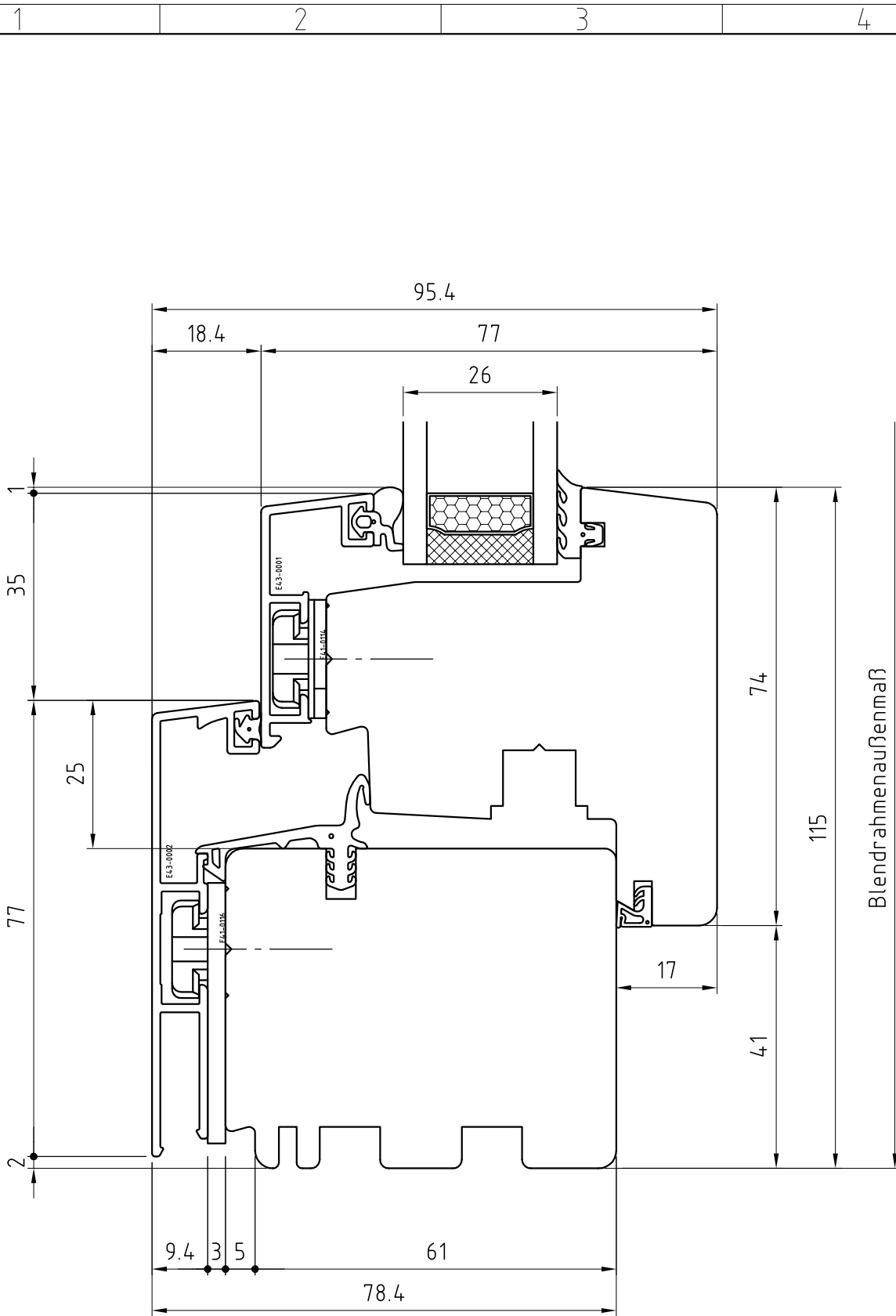

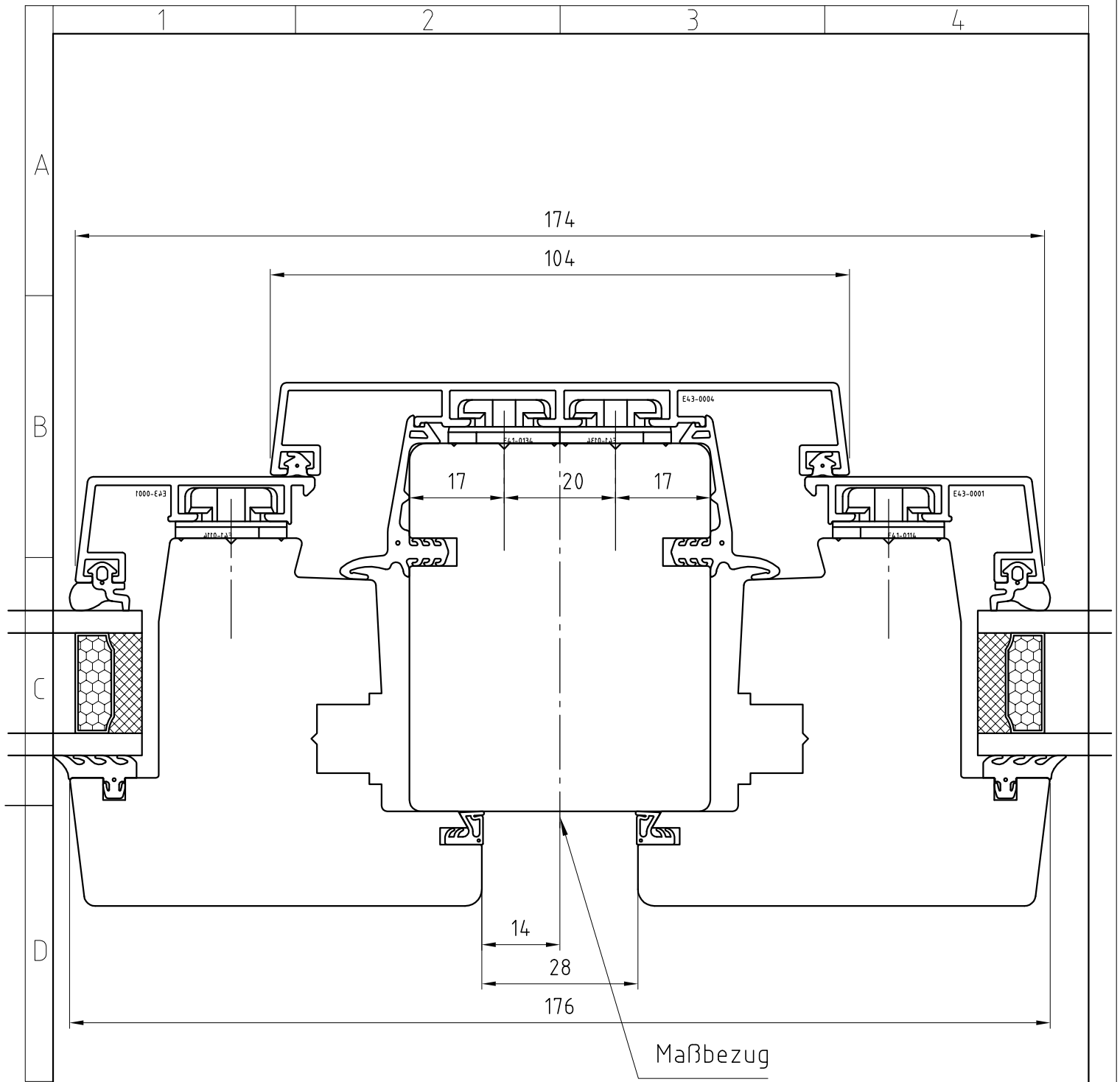

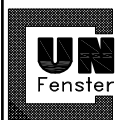
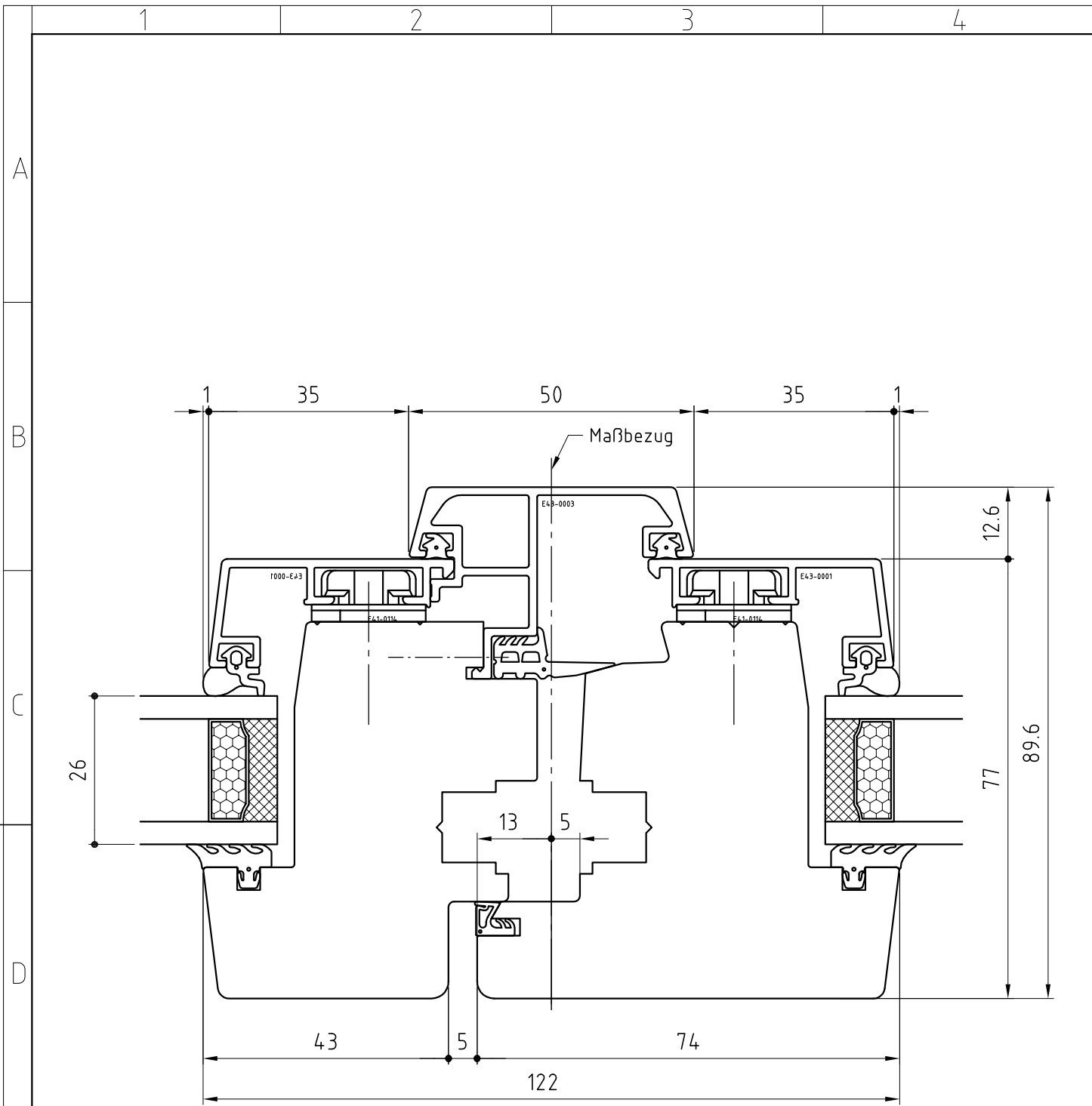

UNILUX AG
 Industriegebiet
 54528 Salmthal
 Tel. 06578/189-0
 Fax 06578/1880

Holz-Aluminium
 ModernLine
 Stulppartie

Maßstab 1:1